

From the idea to the finished object

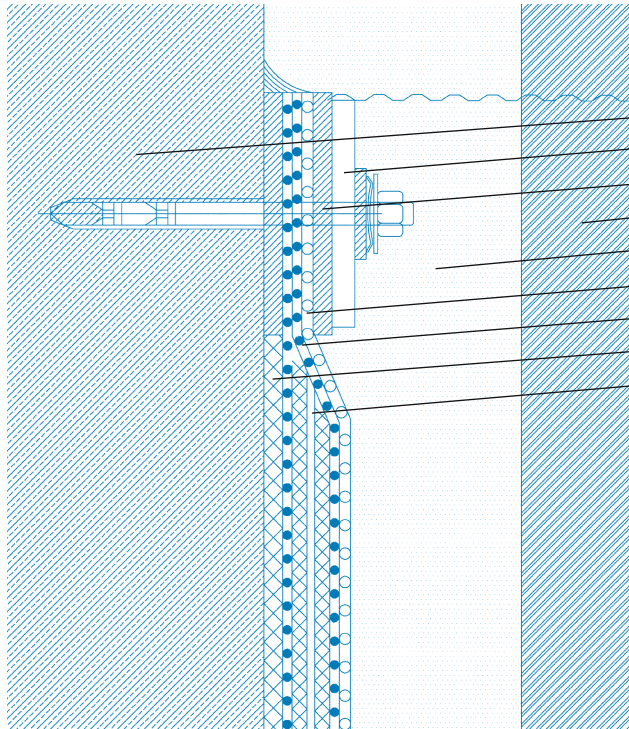

- Concrete support structure
- Fan jet 6/60 mm
- Neoprene
- Water borderstone
- Mortar filling 45 mm
- Protective layer 3 mm
- Waterproof layer 2,5 mm
- Fleece 500 g/m²
- Control sensor

Fitting the waterproof layer with adhesive strip

Interfaces: Natural watercourses are always in a state of dynamic interchange with their surroundings, losing water through outflow, evaporation and infiltration. Artificial water features would quickly lose their water to the surrounding area. To prevent this, the interface is particularly important, as well as sealing.

The interface between inflow, outflow, pipes and walls always presents a potential danger in terms of leaks; this is where most problems occur in practice. Different construction methods are required according to the nature of the seal. Connections through sheeting require fundamentally different flange constructions from those used for pierced concrete, for instance. For this reason precise and early planning is needed here, and particularly careful attention must always be paid to the construction and detailing of these points. Some specialist manufacturers offer prefabricated pipe ducting for seals of all kinds.

Detail of pipework

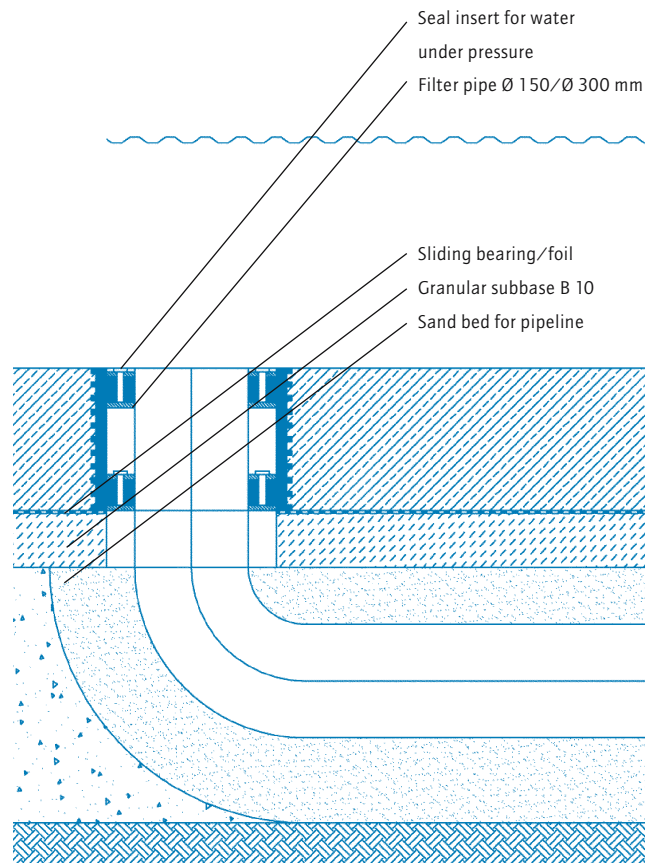

- Seal insert for water under pressure
- Filter pipe Ø 150/Ø 300 mm
- Sliding bearing/foil
- Granular subbase B 10
- Sand bed for pipeline