

Major references

Breen, Ann and Dick Rigby (1996). *The New Waterfront: A World Wide Success Storey*. London: Thames and Hudson.

Heng Chye Kiang (2000). The night zone storyline: Boat Quay, Clarke Quay and Robertson Quay.

Traditional Buildings and Settlements Review XIX (Spring): 41–9.

Heng Chye Kiang (2001). Singapore River: a case for a river of life. *Singapore Architect* 211 (September): 90–5.

Precincts: Housing Complexes

Some may argue that the Barbican is really ‘just’ a housing development but there are thousands of housing schemes around the world that are much more single use in nature. They follow an extraordinarily range of forms based on a variety of antecedent ideas. The Rationalist schemes generally follow models developed at the Bauhaus in Germany and advocated by architects such as Ludwig Hilbersheimer (see Figure 7.18), and by Le Corbusier in his proposals for ideal cities and neighbourhoods that culminated in the building of his Unité d’Habitation (see Chapter 6). Such forms still dominate residential area design in many countries today. Pruitt-Igoe is a 1950s American example.

The Empiricist proposals have either followed Garden City and neighbourhood unit principles or were simply pragmatic, financially driven schemes led by property developers. Private ownership was stressed. Lately many such residential area designs have been driven by New Urbanist ideas. The most important

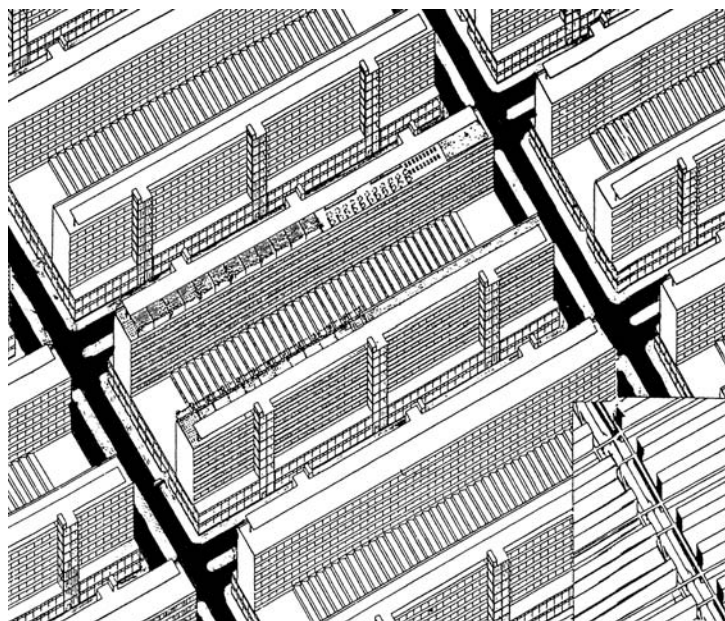

Adapted from Hilbersheimer (1940)

Figure 7.18 A generic Bauhaus-type residential area design as presented by Ludwig Hilbersheimer.