

## Riva Split Waterfront

**Location:** Split, Croatia **Designer:** 3HLD **Photographer:** Damir Fabijanic  
**Completion date:** 2007 **Site area:** 24,707 sqm

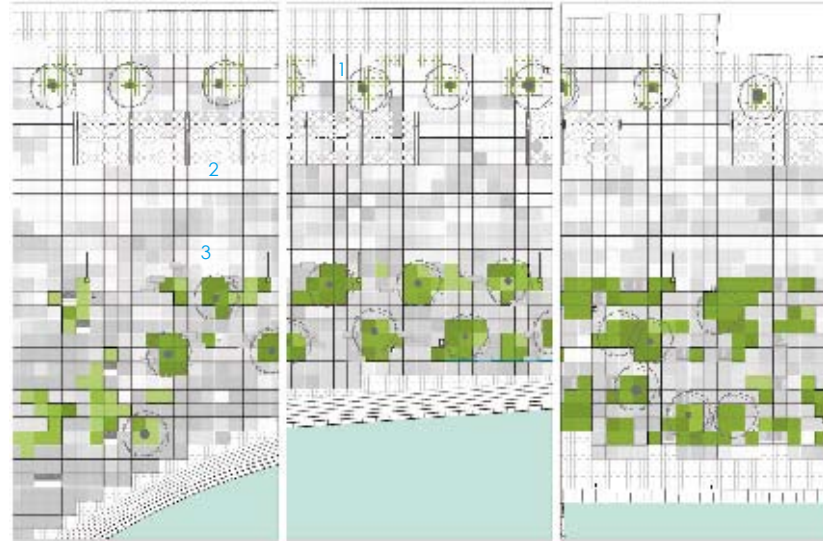

1. Trees  
 2. Shading Support  
 3. Benches

The city of Split and its waterfront, the Riva, as the paradigm of its history and character, are among the most interesting and most specific sites in the Mediterranean. Split waterfront is an urbanised, public, open and accessible space, 1,700 years old. It stands in front of Diocletian's Palace, once the home of the Roman emperor. The modular Roman form of the palace in the latter phase became the framework that shaped the city and directed its expansion; in the same way, the dimensions, materials and form of the modular network of concrete elements laid on Riva directed the arrangement and positions of all the other elements of the public space. The waterfront is the focal point where the city meets the sea. 250 metres long and 55 metres wide, it is also the main public square, the space for all kinds of social events, promenade by day, parade by night, the site of sport events, religious processions, festivals and celebrations. The project rearticulates the space for all the mentioned events and harmonises them on a new integrated surface. The solution uses not only architectural design, but also materials, to respond to all the challenges of utilisation set before the Riva. All urban elements and equipment was specially designed for this project and they try to meet local spirit and atmosphere.

Right: Aerial view of Riva Split

