

TABLE 4.16 Ratio of the Length of the Wall between Lateral Supports (L) to the Thickness of the Wall (T) for Freestanding Walls at Given Wind Pressures

Design wind pressure, lb/in ²	Maximum L/T
5	35
10	25
15	20
20	18
25	16
30	14
35	13
40	12

SOURCE: From Harlow C. Landpahir and Fred Klatt, Jr., *Landscape Architecture Construction*, 2d ed. (New York: Elsevier Science Publishing, 1988), p. 208.

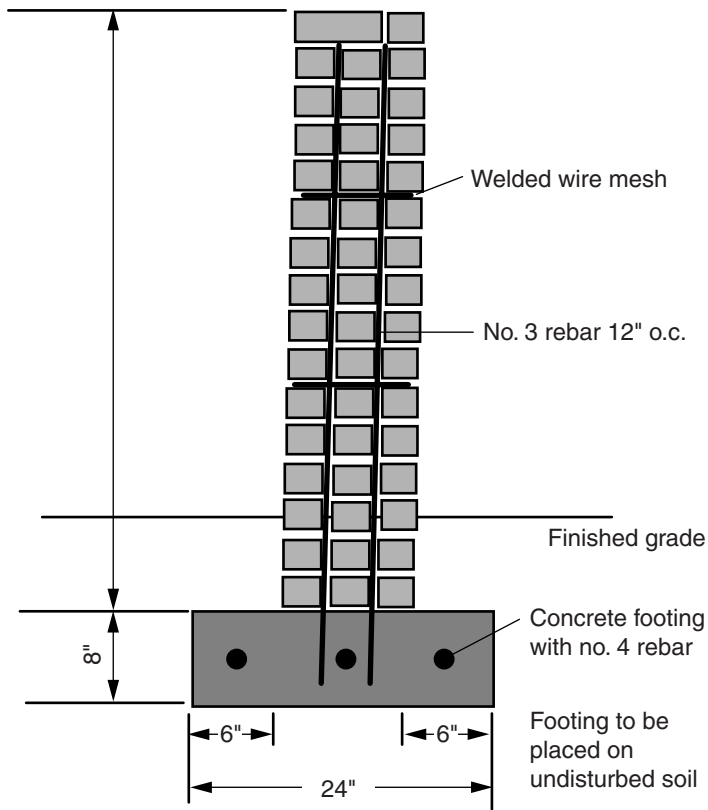

Figure 4.62 Brick wall detail.